

Dítec
OPEN YOUR WORLD



SMART



ENERGY
SAVING



SAFE

Automatic
barriers
for free passages
up to **6 m**

Dítec **SPID**

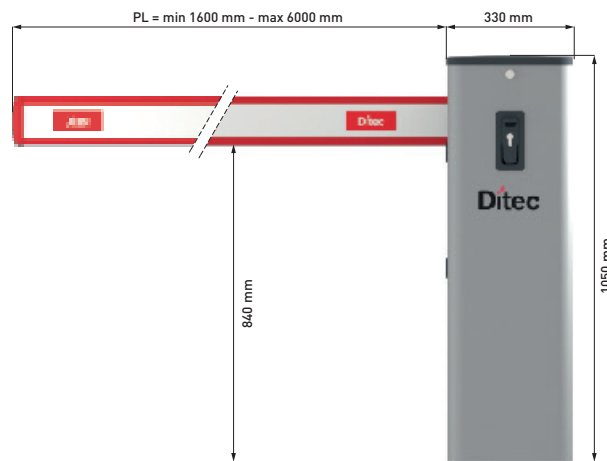
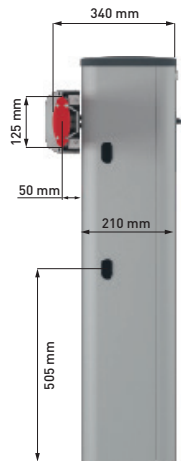
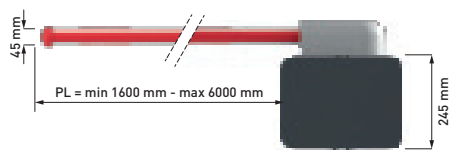

TECHNICAL SPECIFICATIONS

DESCRIPTION	SPID40B	SPID60B
Free passage	Up to 4 m	Up to 6 m
Arm length	Low-profile arm up to 4.2 m (SPB range) Elliptical profile arm up to 4.2 m (EPB range)	Low-profile arm up to 4.2 m (SPB range) Elliptical profile arm up to 6.2 m (EPB range)
Stroke control	Virtual encoder	Virtual encoder
Service index	Very intense Tested up to 2,500,000 cycles	Very intense Tested up to 2,500,000 cycles
Intermittent operation	Continuous use	Continuous use
Cycles/hour*	320 cycles/h (T=25°C)	240 cycles/h (T=25°C)
Power absorption	100 Vac - 240 Vac 50-60 Hz	100 Vac - 240 Vac 50-60 Hz
Motor output	24 Vdc - 10 A max	24 Vdc - 10 A max
Opening and closing speed	2.5 s - 6 s/90° (2 s - 5.5 s/80° + 0.5 s deceleration)	3.5 s - 6 s/90° (3 s - 5.5 s/80° + 0.5 s deceleration)
Release system for manual opening	Exterior with key handle / interior with lever	Exterior with key handle / interior with lever
Operating temperature	-20°C/+55°C (-35°C/+55°C with NIO enabled)	-20°C/+55°C (-35°C/+55°C with NIO enabled)
Protection level	IP 54	IP 54

* A cycle is defined as an opening maneuver → pause → closing maneuver → pause (T = 25°C).

SPID40B: indicative cycles considering a 4.2 m arm with predefined opening/closing speed. SPID60B: indicative cycles considering a 6.2 m arm with predefined opening/closing speed.

MAIN FUNCTIONS OF THE SYSTEM

TECHNICAL SPECIFICATIONS

Control panel	LCU55 built-in
Radio module	RCB100E (433.92 default - 868.35 Mhz selectable)
Bluetooth®	Integrated
Accessories power supply	24 Vdc / 0.5 A
Energy saving	< 0.6 W for SPID40B and < 0.8 W for SPID60B with display and Bluetooth® activated
Operating temperature	-20°C ÷ +55°C in standard conditions -35°C ÷ +55°C with NIO enabled

INPUTS

Step-by-step control	■
Opening control	Shared with step-by-step control, selectable from display
Partial opening control	■
Close control	Shared with partial opening control, selectable from display
Stop control	■ or via radio
Hold-to-run control	Shared with stop control, selectable from display
Automatic closing contact management (enables or disables automatic closure via external timer or remote signal)	Shared with partial opening control, selectable from display

OUTPUTS

Number of 24 Vdc outputs	2
- Flashing light	24 Vcc
- Electrically operated lock	■
- Gate-open warning light (ON/OFF)	■
- Gate-open warning light with proportional blink rate	■
- Courtesy light	■
- LED light on the arm	■
C-NO output configurable to 230 Vac	1, up to 2 A
- Flashing light	230 Vca

- Courtesy light	■
- Contact always closed - contact always open	■
- Automation closed, open, moving, opening, closing	■

PROGRAMMABLE FUNCTIONS

Stroke control	Virtual encoder display and navigation buttons
Configuration of programmable functions	Via App
Speed	■ adjustable
Automatic re-closing time	■ adjustable
Pre-flashing time in opening and closing	■ adjustable
Opening and closing thrust on obstacle	■ adjustable
Automatic lock reset after release of the safety device	■ adjustable
Integrated datalogging (counter and recent alarm history)	■
Monitoring the level of automation efficiency	■
FW Update	■ via SW FlashIT and USBPROG or via App

SAFETY AND PROTECTION FUNCTIONS

Emergency stop	■
Safe closing (inversion)	■
Automatic force adjustment during movement	■
D-ODS Dynamic Obstacle Detection system (automatic adjustment of the thresholds to reduce the possibility of false obstacle detection)	■

OPTIONAL ACCESSORIES

Batteries	■ available soon
Magnetic loop detector	■
Electromagnetic lock integrated on fixed rod support	■



Ditec S.p.A.

Largo U. Boccioni, 1
21040 Origgio (VA) • Italy

Part of ASSA ABLDY

Tel +39 02 963911
info@ditecautomations.com
www.ditecautomations.com

Technical data subject to change without notice